

Ersatzteile ZA 22-1 / D

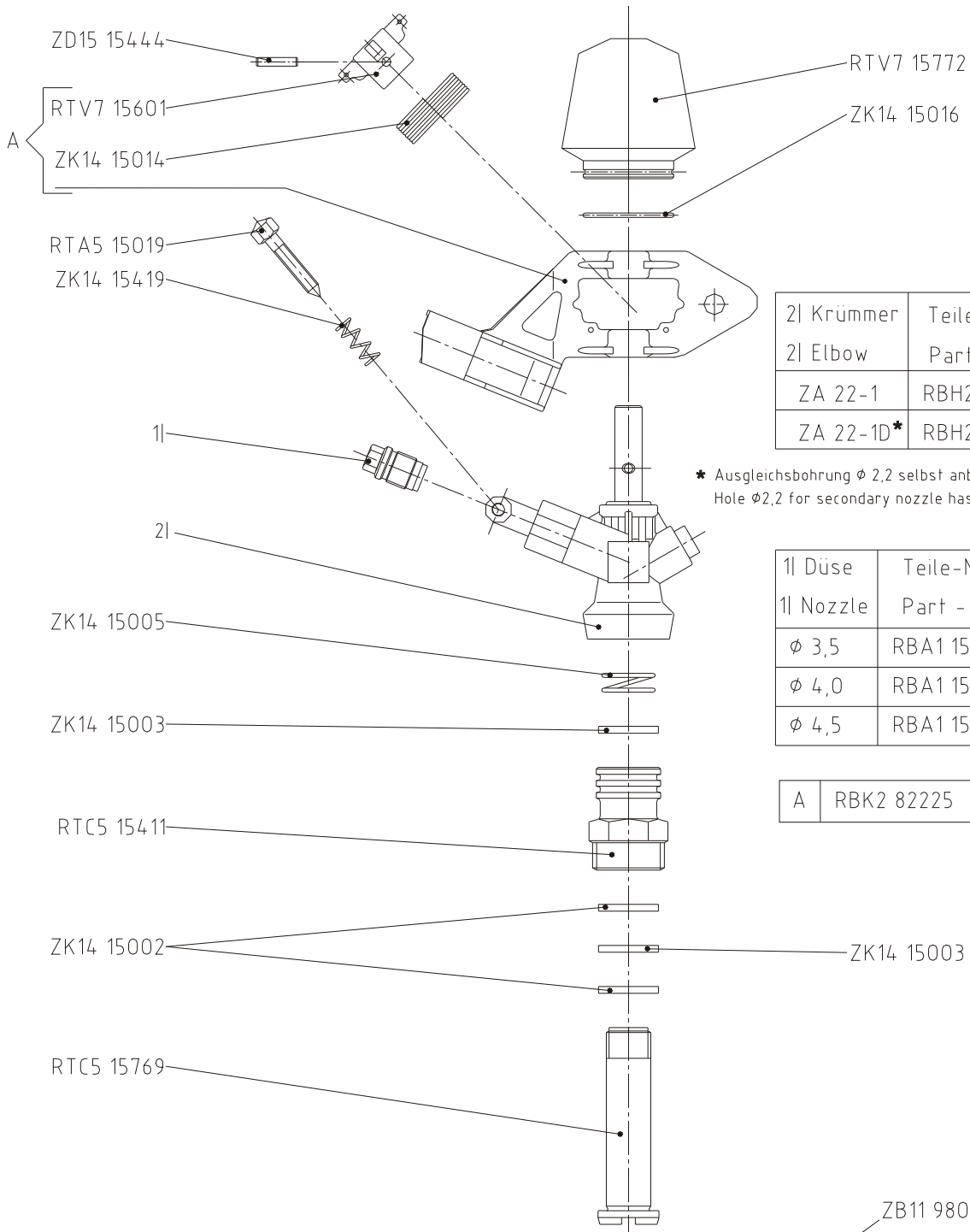

2 Krümmer	Teile-Nr.
2 Elbow	Part-No.
ZA 22-1	RBH2 15766
ZA 22-1D*	RBH2 15766

* Ausgleichsbohrung ϕ 2,2 selbst anbringen!
Hole ϕ 2,2 for secondary nozzle has to be drilled!

1 Düse	Teile-Nr.
1 Nozzle	Part - No.
ϕ 3,5	RBA1 15691
ϕ 4,0	RBA1 15696
ϕ 4,5	RBA1 15698

A	RBK2 82225
---	------------

Montage-Werkzeuge
Assembling tools

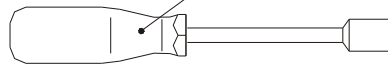
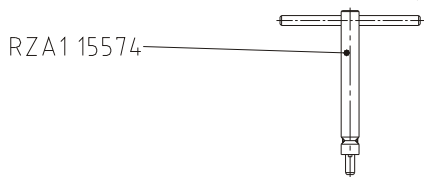

Ersatzteile ZA 22-2 W

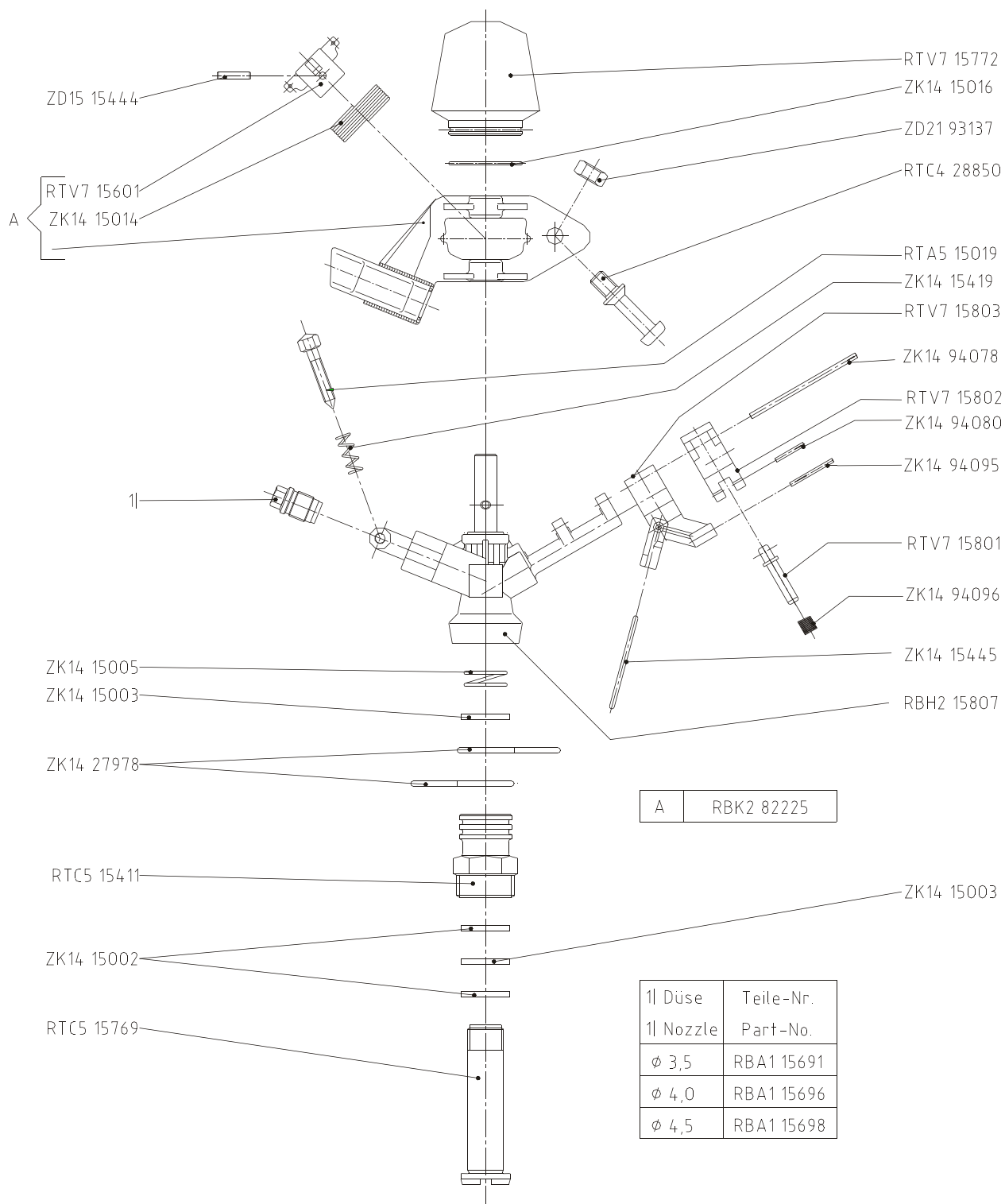

A RBK2 82225

1 Düse	Teile-Nr.
1 Nozzle	Part-No.
∅ 3,5	RBA1 15691
∅ 4,0	RBA1 15696
∅ 4,5	RBA1 15698

Montage-Werkzeuge
Assembling tools

